

FOUNDATION

INV. AT BLDG. = 222.50
WATERIGHT JOINT (SEE LOCAL PLUMBING RECS.)

4" PVC TEE WITH GAS BAFFLE

CONC. COVER TOP S.T. = 223.4±
FINISH GRADE 9" MIN., 36" MAX.
ABOVE TOP OF TANK (RISER TO WITHIN 6" OF FINISH GRADE)

4" PVC TEE WITH GAS BAFFLE

INV. IN S.T. = 222.30

20" DIA. MIN.

2" MIN., 3" MAX. LIQUID LEVEL

1000 GAL. 500 GAL.

4" SOLID SCH. 40 PVC APPROVED EQUAL 1/8" FT. MIN.

INV. OUT S.T. = 222.05

NOTE:
AS PER TITLE 5, ALL COMPONENTS OF THE SEWAGE DISPOSAL SYSTEM SHALL BE MARKED WITH MAGNETIC TAPE PRIOR TO BACKFILL.

INV. OUT = 221.63 HIGH INV. = 221.50

VENT ENDS

TOP STONE = 222.00 LOW INV. = 221.35 BOT. STONE = 220.85

CRT. DEPTH BELOW PIPE = 6"

LENGTH = 30' WIDTH = 15'

1500 GALLON SEPTIC TANK DISTRIBUTION BOX LEACHING FIELD 30' x 15' = 450 S.F.

SCHEDULE OF ELEVATIONS	PROPOSED	AS-BUILT
TOP CONCRETE FOUNDATION	228.00	
INVERT AT FOUNDATION	222.50	----
INVERT TANK INLET	222.30	----
INVERT TANK OUTLET	222.05	----
TOP SEPTIC TANK	223.4*	----
INV. "D" BOX INLET	221.80	----
INV. "D" BOX OUTLET	221.63	----
TOP OF STONE	222.00	
INVERT HIGH END	221.50	----
INVERT LOW END	221.35	----
BOTTOM OF STONE	220.85	
GROUNDWATER OFFSET REQUIRED	5'	
GROUNDWATER OFFSET UTILIZED	5'+	

[illegible]

FLOWS: 3 BEDROOMS AT 110 GPD = $\frac{330}{(330 \text{ GPD MIN.})}$ GPD
 SEPTIC TANK REQUIRED: ($\frac{1500}{330}$ GAL. MIN.)
 $\frac{330}{330}$ GPD X 2.0 = $\frac{660}{660}$ GAL. TANK

LEACHING AREA PROVIDED:

A. BASIS 2 MIN./IN. PERCOLATION RATE

B. APPLICATION RATE ALLOWED 0.74 S.F.

C. BOTTOM AREA PROVIDED = 450 S.F.

D. TOTAL G.P.D. PROVIDED 333

SYSTEM IN FILL ☐ **REQUIRED** ☐ **NOT REQUIRED**

IF ANY PORTION OF THE PROPOSED LEACHING AREA IS LOCATED ABOVE EXISTING GRADE OR WITHIN TOPSOIL, SUBSOIL, PEAT OR OTHER UNSUITABLE OR IMPERVIOUS SOIL LAYER, THEN THE PLACEMENT OF FILL SHALL BE LIMITED TO THE LAYER OF SOIL THAT IS PERMEABLE OR IMPERMEABLE SOILS SHALL BE EXCAVATED TO A MINIMUM OF FIVE FEET LATEROALLY IN ALL DIRECTIONS BEYOND THE OUTER PERIMETER OF THE EXISTING LAYER OF IMPERMEABLE SOIL. THE EXCAVATION SHALL BE FILL WITH IMPERVIOUS MATERIAL. FILL MATERIAL SHALL BE SELECTED, ON-SITE OR IMPORTED SOIL, CONSISTING OF CLEAN GRANULAR SAND, FREE FROM ORGANIC MATTER AND OTHER DELETERIOUS SUBSTANCES, UNBURNED COAL OR LIGNITE, AND OTHER SUBSTANCES THAT MAY BE HARMFUL TO THE FILL. FILL SHALL NOT CONTAIN ANY MATERIAL LARGER THAN TWO INCHES. A SEIVE ANALYSIS USING A #4 SEIVE, SHALL BE PERFORMED ON A MINIMUM OF FIVE (5) SAMPLES PER 1000 CY OF FILL. ONE OF THE FILL SAMPLE MAY BE RETAINED IN THE #4 SEIVE. SEIVE ANALYSES SHALL ALSO BE PERFORMED ON THE FRACTION OF FILL SAMPLE PASSING THE #4 SEIVE. THE ANALYSES SHALL BE USED TO DETERMINE THAT THE MATERIAL MEETS EACH OF THE FOLLOWING SPECIFICATIONS:

SIEVE SIZE	EFFECTIVE PARTICLE SIZE	% THAT MUST PASS SIEVE
# 4	4.75 MM	100%
# 50	0.30 MM	10%-100%
#100	0.15 MM	0%-20%
#200	0.075 MM	0%-5%

WETLAND PROTECTION ACT (C131 S40)
 PRIOR TO INITIATING ANY ALTERATIONS (REMOVAL OF VEGETATION, EXCAVATIONS, GRADING, ETC.) WITHIN 100' OF WETLANDS (PONDS, BROOKS, SWAMPS, ETC.) OR WITHIN 200' OF AN AREA SUBJECT TO THE RIVER'S ACT (PERENNIALY FLOWING RIVER, BROOK OR STREAM), A REQUEST FOR DETERMINATION OF APPLICABILITY OR A NOTICE OF INTENT UNDER THE WETLANDS PROTECTION ACT (310 CMR 10.00) SHOULD BE FILED WITH THE TOWN'S CONSERVATION COMMISSION. LOCAL BYLAWS MAY ALSO APPLY.

SEWAGE DISPOSAL SYSTEM

FOR: LOT --- STREET LAKEVIEW AVENUE

ASSESSOR'S MAP 65 PARCEL 17

TOWN: BELLINGHAM, MASSACHUSETTS

DESIGNED FOR

QUARRY DEVELOPMENT, LLC

SCALE: 1" = 20' MAY, 2025

S E T H L . L A J O I E & A S S O C I A T E S

REGISTERED SANITARIANS, TOPOGRAPHIC SURVEYS
PERCOLATION TESTING, ENVIRONMENTAL CONSULTANTS
27 BECKET STREET SOLEM, MA 01970
CELL: (774) 230-7029

JOB NO. 1119 SHEET 1 OF 1 PLAN NO. L-916

OBSERVATION TEST HOLE DATA
 PERFORMED BY: SETH L. LAJOIE, LAJOIE ASSOCIATES
 WITNESSED BY: BRUCE WILSON, AGENT
 11/14/2024

1124-1 ELEV. = 225.0 <div style="display: flex; justify-content: space-between;"> <div style="width: 30%;"> 0"-12" 12"-24" 24"-120" </div> <div style="width: 30%;"> Ap Bw C </div> <div style="width: 30%;"> FINE SANDY LOAM LOAMY SAND LOAMY SAND </div> </div>	1124-2 ELEV. = 225.0 <div style="display: flex; justify-content: space-between;"> <div style="width: 30%;"> 0"-12" 12"-24" 24"-120" </div> <div style="width: 30%;"> Ap Bw C </div> <div style="width: 30%;"> FINE SANDY LOAM LOAMY SAND LOAMY SAND </div> </div>
NO MOTTLING OBSERVED TO 120" (ELEV. = 215.00) NO GROUNDWATER OBSERVED E.S.H.W.T. = 120" NO REFUSAL	NO MOTTLING OBSERVED TO 120" (ELEV. = 215.00) NO GROUNDWATER OBSERVED E.S.H.W.T. = 120" NO REFUSAL

1124-3 ELEV. = 227.0 <div style="display: flex; justify-content: space-between;"> <div style="width: 30%;"> 0"-12" 12"-24" 24"-120" </div> <div style="width: 30%;"> Ap Bw C </div> <div style="width: 30%;"> FINE SANDY LOAM LOAMY SAND LOAMY SAND </div> </div>	1124-4 ELEV. = 227.0 <div style="display: flex; justify-content: space-between;"> <div style="width: 30%;"> 0"-12" 12"-24" 24"-120" </div> <div style="width: 30%;"> Ap Bw C </div> <div style="width: 30%;"> FINE SANDY LOAM LOAMY SAND LOAMY SAND </div> </div>
NO MOTTLING OBSERVED TO 120" (ELEV. = 217.00) NO GROUNDWATER OBSERVED E.S.H.W.T. = 120" NO REFUSAL	NO MOTTLING OBSERVED TO 120" (ELEV. = 217.00) NO GROUNDWATER OBSERVED E.S.H.W.T. = 120" NO REFUSAL

"I CERTIFY THAT ON MAY 27, 1999 I HAVE PASSED THE
 EXAMINATION APPROVED BY THE DEPARTMENT OF ENVIRONMENTAL
 PROTECTION AND THAT THE ABOVE ANALYSIS HAS BEEN PERFORMED
 BY ME CONSISTENT WITH THE REQUIRED TRAINING, EXPERTISE, AND
 EXPERIENCE DESCRIBED IN 310 CMR 15.018(2)"

NAME: SETH L. LAJOIE

SEPTIC TANK

SEPTIC TANK SHALL BE A PRECAST, REINFORCED CONCRETE TANK MADE WATERTIGHT. CONSTRUCTION MATERIALS AND DIMENSIONS SHALL CONFORM TO TITLE 5 AND AASHTO HS 10 REQUIREMENTS AND PLACED ON A STABLE MECHANICALLY COMPACTED LEVEL BASE.

TANK/ SYSTEM TO BE VENTED THROUGH THE BUILDING PLUMBING SYSTEM AS REQUIRED BY BUILDING CODE.

TANK SHOULD BE INSPECTED, MAINTAINED AND BE PUMPED OUT WHEN SLUDGE DEPTH IN THE BOTTOM EXCEEDS ONE FOURTH OF THE TOTAL LIQUID DEPTH.

AT LEAST THREE 20" MANHOLES SHALL BE PROVIDED. AT LEAST ONE OF THE MANHOLES SHALL HAVE AN ACCESS PORT ACCESSIBLE TO WITHIN 6" OF FINISH GRADE.

"D" BOX

"D" BOX TO BE MADE WATERTIGHT. CONSTRUCTION MATERIALS AND DIMENSIONS SHALL CONFORM TO TITLE 5 AND AASHTO HS 10 REQUIREMENTS AND PLACED ON A STABLE MECHANICALLY COMPACTED LEVEL BASE.

LEACH AREA

ALL LOAM, LARGE BOULDERS OR FOREIGN MATERIAL ENCOUNTERED DURING EXCAVATION ARE TO BE REMOVED FROM THE LEACHING AREA.

ALL SOIL INTERFACES SHALL BE SCARIFIED PRIOR TO THE PLACEMENT OF STONE.

ALL STONE IN PLACE SHALL BE DURABLE, FREE FROM IRON, FINES AND DUST AND DOUBLE WASHED.

WHEN GRAVEL FILLS IS REQUIRED, ALL LOAM AND ORGANIC MATERIAL SHALL BE REMOVED FROM AREA TO BE FILLED. FILLS SHALL BE COMPACTED TO MINIMIZE SETTLEMENT AND SHALL BE CLEAN GRANULAR MATERIAL, FREE FROM FINES AND ORGANIC MATERIALS, AND SHALL BE IN ACCORDANCE WITH 310 CMR 15.255(3).

ALL DISTURBED AREAS ARE TO BE LOADED, SEEDED AND MAINTAINED TO PREVENT EROSION.

AREAS ABOVE THE SOIL ABSORPTION SYSTEM SHALL REMAIN PERVIOUS UNLESS UNAVOIDABLE. IN SUCH CASES THE SYSTEM SHALL BE VENTED.

GENERAL NOTES

GENERAL NOTES

SYSTEM IS DESIGNED TO ACCOMMODATE SANITARY SEWAGE ASSOCIATED WITH NORMAL DOMESTIC USE AND CONSISTING OF WATER CARRIED PUTRESIBLE WASTE ONLY.

ALL COMPONENTS OF THE SEWAGE DISPOSAL SYSTEM SHALL BE COVERED BY A MAXIMUM OF 36" OF CLEAN BACKFILL MATERIAL, FREE OF STONES AND BouldERS GREATER THAN 6" IN SIZE.

OWNER SHALL VERIFY EFFECTIVE ZONING REGULATIONS PRIOR TO CONSTRUCTION.

PLAN SHOWS ONLY THOSE FEATURES THAT WERE VISUALLY APPARENT ON DATE OF TOPOGRAPHY, AND THE ABSENCE OF SUBSURFACE STRUCTURES, UTILITIES, ETC. IS NOT INTENDED OR IMPLIED.

ALL PIPING SHALL BE LAID TRUE TO LINE, GRADE AND INSTALLED IN ACCORDANCE WITH MANUFACTURER'S RECOMMENDATIONS.

THERE ARE NO EXISTING WELLS WITHIN 100' OF THE PROPOSED SEWAGE DISPOSAL SYSTEM. (50' OF THE SEPTIC TANK.) THERE ARE NO EXISTING SEWAGE DISPOSAL SYSTEMS WITHIN N/A OF THE PROPOSED WELL.

TOWN WATER PROVIDED.

ALL KNOWN WELLS WITHIN 200' OF THE PROPOSED PRIMARY AND EXPANSION LEACH AREAS ARE SHOWN.

THE DESIGN ENGINEER SHALL BE NOTIFIED PROMPTLY OF ANY PLAN DISCREPANCIES FOUND DUE TO UNFORESEEN SUBSURFACE CONDITIONS OR OTHER REASONS THAT MIGHT AFFECT THE FUNCTION OF THIS DESIGNED

DEVIATIONS IN DESIGN OR CONSTRUCTION FROM THIS PLAN OR ANY OF THE CONDITIONS RELATING TO THE USE OR MAINTENANCE OF THE PROPOSED SYSTEM SHALL BE DEEMED TO VOID ANY CERTIFICATION OR REPRESENTATION MADE RELATIVE TO THIS SUBSURFACE SEWAGE DISPOSAL SYSTEM.

CONTRACTOR SHALL NOTIFY "DIG SAFE" PRIOR TO ANY EXCAVATION.
1-888-DIG-SAFE (344-7233)

PRIOR TO ANY CONSTRUCTION A BENCHMARK SHALL BE SET WITHIN 50'-75' OF THE PROPOSED SEWAGE DISPOSAL SYSTEM.

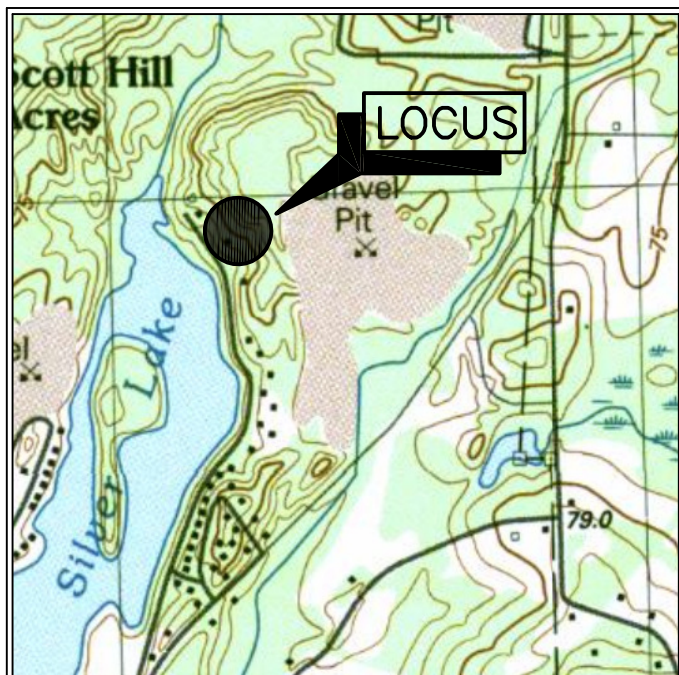
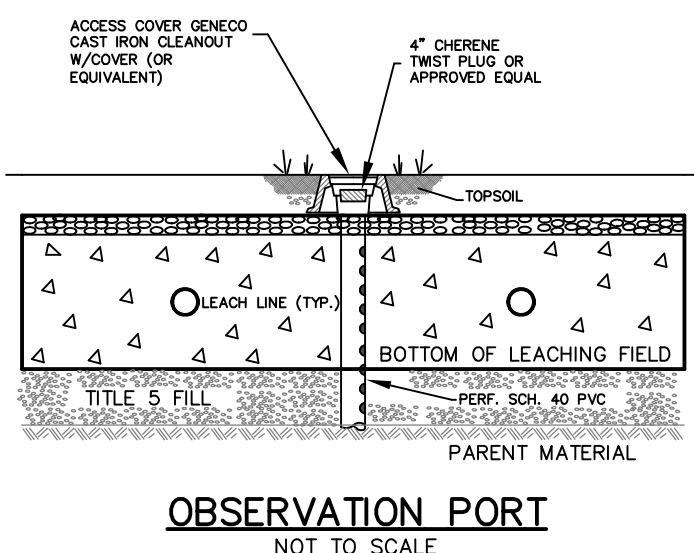
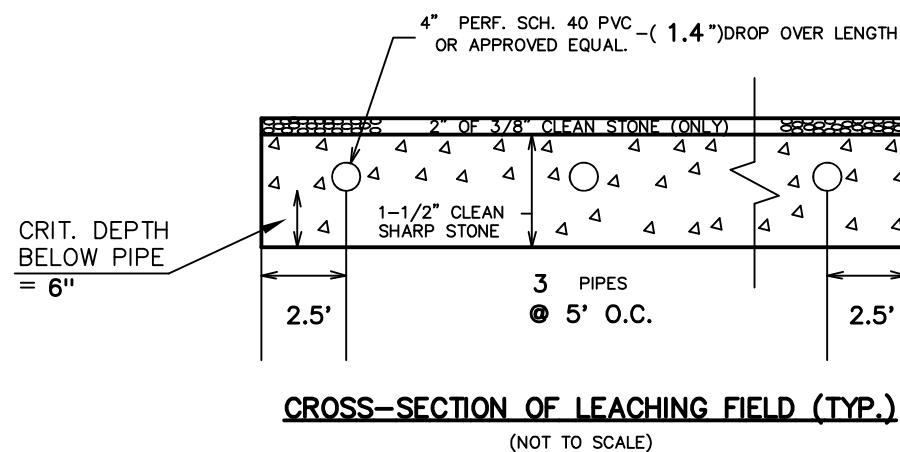
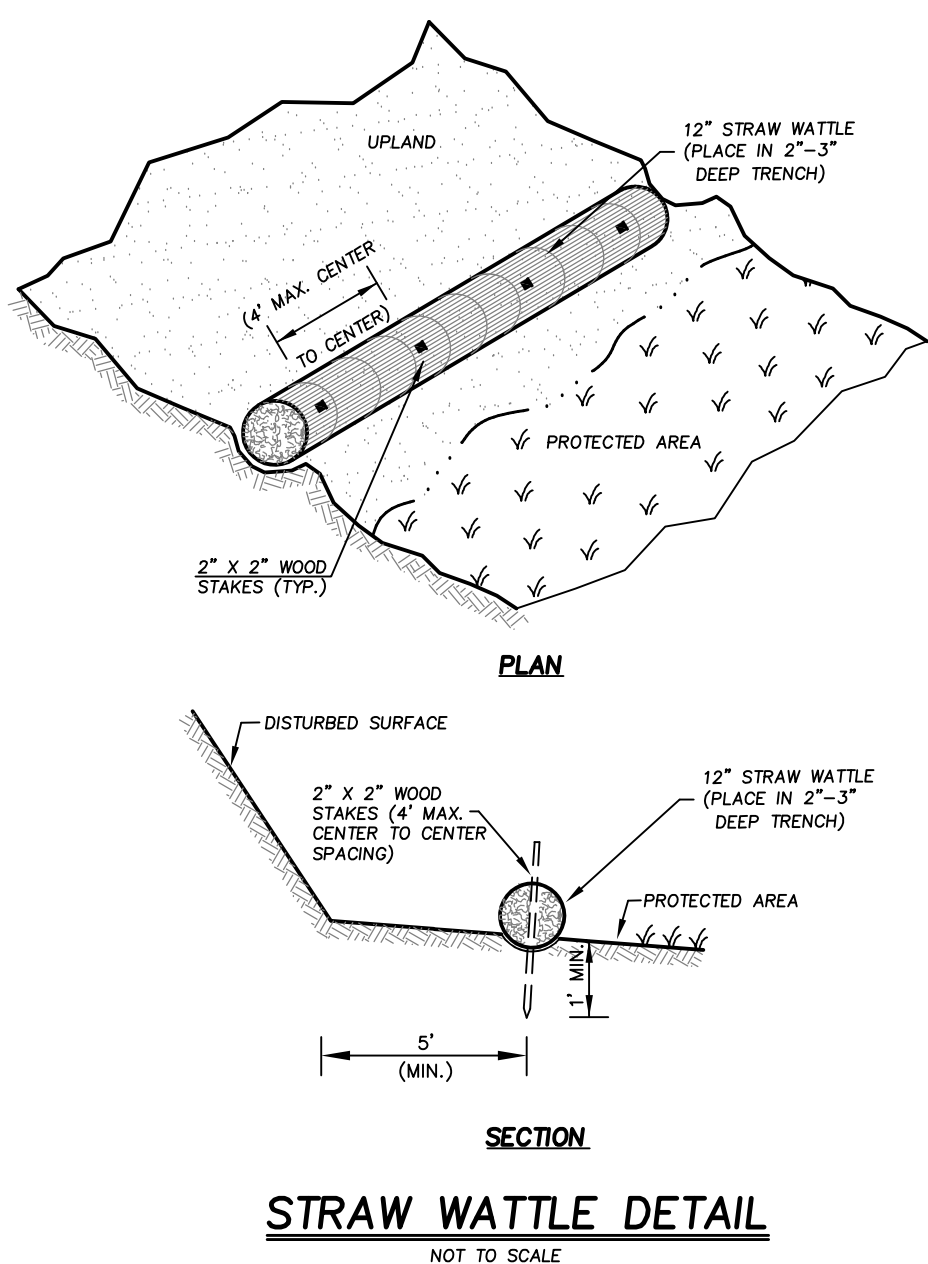

COMMONWEALTH OF MASSACHUSETTS
SETH L.
LAJOIE
No. 12 444
REGISTERED
PROFESSIONAL LAND SURVEYOR
05/13/2025

REVISIONS

05/13/25 - ORIGINAL ENDORSEMENT