



**Massachusetts Department of Environmental Protection &
Bellingham Wetlands Protection Bylaw**
Bureau of Resource Protection - Wetlands

City/Town _____

WPA Form 1- Request for Determination of Applicability

Massachusetts Wetlands Protection Act M.G.L. c. 131, §40

A. General Information

Important:

When filling out forms on the computer, use only the tab key to move your cursor - do not use the return key.



1. Applicant:

Danielle D'Amato

ddamato23@gmail.com

Name

E-Mail Address

49 Lakeshore Drive

Mailing Address

Bellingham

MA

02019

City/Town

State

Zip Code

508-944-5173

Phone Number

Fax Number (if applicable)

2. Representative (if any):

Charron Tree Service

Firm

Sean Webber

sean.webber@charrontreeservices.com

Contact Name

E-Mail Address

1060 Pulaski Blvd

Mailing Address

Bellingham

MA

02019

City/Town

State

Zip Code

508-883-8823

Phone Number

Fax Number (if applicable)

B. Determinations

1. I request the Bellingham Conservation make the following determination(s). Check any that apply:
Conservation Commission

- ☐ a. whether the **area** depicted on plan(s) and/or map(s) referenced below is an area subject to jurisdiction of the Wetlands Protection Act.
- ☐ b. whether the **boundaries** of resource area(s) depicted on plan(s) and/or map(s) referenced below are accurately delineated.
- ☒ c. whether the **work** depicted on plan(s) referenced below is subject to the Wetlands Protection Act.
- ☒ d. whether the area and/or work depicted on plan(s) referenced below is subject to the jurisdiction of any **municipal wetlands ordinance** or **bylaw** of:

Name of Municipality

- ☐ e. whether the following **scope of alternatives** is adequate for work in the Riverfront Area as depicted on referenced plan(s).



**Massachusetts Department of Environmental Protection &
Bellingham Wetlands Protection Bylaw**
Bureau of Resource Protection - Wetlands

City/Town

WPA Form 1- Request for Determination of Applicability

Massachusetts Wetlands Protection Act M.G.L. c. 131, §40

C. Project Description

1. a. Project Location (use maps and plans to identify the location of the area subject to this request):

49 Lakeshore Drive

Street Address

Bellingham

City/Town

0074-0067-0000

Parcel/Lot Number

Assessors Map/Plat Number

- b. Area Description (use additional paper, if necessary):

The area between the house and the lake consists of a steep, sloped section of ground with exposed soil and a retaining wall. The grade makes the space largely unusable.

- c. Plan and/or Map Reference(s):

AxisGIS

Title

11/20/2025

Date

Title

Date

Title

Date

2. a. Work Description (use additional paper and/or provide plan(s) of work, if necessary):

To request approval for the removal of a mature Northern Red Oak (*Quercus rubra*) located in the rear yard on a steep slope. The tree has a diameter at breast height (DBH) of 21.65 inches.



**Massachusetts Department of Environmental Protection &
Bellingham Wetlands Protection Bylaw**
Bureau of Resource Protection - Wetlands

City/Town _____

WPA Form 1- Request for Determination of Applicability

Massachusetts Wetlands Protection Act M.G.L. c. 131, §40

C. Project Description (cont.)

b. Identify provisions of the Wetlands Protection Act or regulations which may exempt the applicant from having to file a Notice of Intent for all or part of the described work (use additional paper, if necessary).

See attached Letter from certified arborist and described work from Charron Tree Service

3. a. If this application is a Request for Determination of Scope of Alternatives for work in the Riverfront Area, indicate the one classification below that best describes the project.

- ☐ Single family house on a lot recorded on or before 8/1/96
- ☐ Single family house on a lot recorded after 8/1/96
- ☐ Expansion of an existing structure on a lot recorded after 8/1/96
- ☐ Project, other than a single-family house or public project, where the applicant owned the lot before 8/7/96
- ☐ New agriculture or aquaculture project
- ☐ Public project where funds were appropriated prior to 8/7/96
- ☐ Project on a lot shown on an approved, definitive subdivision plan where there is a recorded deed restriction limiting total alteration of the Riverfront Area for the entire subdivision
- ☐ Residential subdivision; institutional, industrial, or commercial project
- ☐ Municipal project
- ☐ District, county, state, or federal government project
- ☐ Project required to evaluate off-site alternatives in more than one municipality in an Environmental Impact Report under MEPA or in an alternatives analysis pursuant to an application for a 404 permit from the U.S. Army Corps of Engineers or 401 Water Quality Certification from the Department of Environmental Protection.

b. Provide evidence (e.g., record of date subdivision lot was recorded) supporting the classification above (use additional paper and/or attach appropriate documents, if necessary.)



**Massachusetts Department of Environmental Protection &
Bellingham Wetlands Protection Bylaw**
Bureau of Resource Protection - Wetlands

City/Town _____

WPA Form 1- Request for Determination of Applicability

Massachusetts Wetlands Protection Act M.G.L. c. 131, §40

D. Signatures and Submittal Requirements

I hereby certify under the penalties of perjury that the foregoing Request for Determination of Applicability and accompanying plans, documents, and supporting data are true and complete to the best of my knowledge.

I further certify that the property owner, if different from the applicant, and the appropriate DEP Regional Office were sent a complete copy of this Request (including all appropriate documentation) simultaneously with the submittal of this Request to the Conservation Commission.

Failure by the applicant to send copies in a timely manner may result in dismissal of the Request for Determination of Applicability.

Name and address of the property owner:

Danielle D'Amato

Name

49 Lakeshore Drive

Mailing Address

Bellingham

City/Town

MA

State

02019

Zip Code

Signatures:

I also understand that notification of this Request will be placed in a local newspaper at my expense in accordance with Section 10.05(3)(b)(1) of the Wetlands Protection Act regulations.

Danielle D'Amato

Signature of Applicant

11/20/2025

Date

Signature of Representative (if any)

Date



**Application for Permit
Bellingham Wetlands Protection Bylaw & Regulations**

1. Applicant: Name: Danielle D'Amato Phone: 508-944-5173
Address: 49 Lakeshore Drive, Bellingham, MA 02019
E-mail: ddamato23@gmail.com

2. Project Location: Street: _____
Lakeshore Drive
Assessor's Map 2 Parcel\Lot 0074-0067-0000

3. This application is filed simultaneously with and consistent with the Project Filing

Guidelines found on the town web site for:

- ☒ Request for Determination of Applicability
☐ Abbreviated Notice of Resource Area Delineation
☐ Notice of Intent
☐ Abbreviated Notice of Intent
☐ Amendment Request

Resource Area(s) Delineation to be confirmed: (Please complete number of linear feet)

Linear Feet

0 Bordering Vegetated Wetlands (BVW)
0 Bordering Land Subject to Flooding (BLSF)
0 Isolated Land Subject to Flooding (ILSF)
0 Isolated Vegetated Wetland (IVW)
0 Land Under Water Bodies (LUWB)
0 Bank
0 Perennial Stream: (MHA W) Stream Name: _____
0 Intermittent Stream:

Is Estimated or Priority Habitat present on the site? Yes _____ No x

Species: N/A

Number of Vernal Pools present on the site: Certified 0 Potential 0

4. Work is proposed in the following Resource Areas:

<input type="checkbox"/> Bank	Total #of square feet of impacts:	_____
<input type="checkbox"/> Beach or Flat	Total #of square feet of impacts:	_____
<input type="checkbox"/> Land Subject to Flooding(bordering or isolated)	Total # of square feet of impacts	_____
<input type="checkbox"/> Bordering Vegetated Wetlands	Total # of square feet of impacts	_____
<input checked="" type="checkbox"/> Buffer Zone	Total # of square feet of impacts	<u>150 Sq Ft.</u>
<input type="checkbox"/> Isolated Wetland	Total # of square feet of impacts	_____
<input type="checkbox"/> Lakes or Ponds	Total # of square feet of impacts	_____
<input type="checkbox"/> Land under Water Bodies	Total # of square feet of impacts	_____
<input type="checkbox"/> Riverfront Area	Total # of square feet of impacts	_____
<input type="checkbox"/> Vernal Pool	Total # of square feet of impacts	_____
	Total # of above	<u>150 Sq Ft.</u>

5. Work is proposed in the following No Alteration Zones:

<input type="checkbox"/> Areas of Critical Environmental Concern	Total# of square feet of impacts	0
<input type="checkbox"/> Buffer Zone 0 -25 feet	Total# of square feet of impacts	0
<input type="checkbox"/> Estimated Habitat	Total# of square feet of impacts	0
<input type="checkbox"/> Priority Habitat	Total# of square feet of impacts	0
<input type="checkbox"/> 0 – 50 feet No Disturb Zone to Vernal Pool	Total# of square feet of impacts	0
	Total of above	0

6. Work in buffer zone only:

<input type="checkbox"/> 0-25 feet	Total# of square feet of impacts	
<input type="checkbox"/> 25-50 feet	Total# of square feet of impacts	
<input checked="" type="checkbox"/> 50-100 feet	Total# of square feet of impacts	150 Sq Ft.
	Total of above	150 Sq Ft.

7. Project Description:

a. Existing Conditions where work is proposed

- | | |
|--|--|
| <input type="checkbox"/> Impervious | <input type="checkbox"/> Lawn or landscaped area |
| <input type="checkbox"/> Regulated Resource Area | <input checked="" type="checkbox"/> Wooded or natural area |
| <input type="checkbox"/> Other | |

b. Description of proposed work: Removal of large northern red oak

c. Type of equipment required for project: Crane will be staged off site. No heavy equipment will be placed in the buffer zone.

d. Type of erosion control proposed: None

8. Plans must adhere to the criteria in Section 29 "Plan Requirements" of the Regulations.

9. Project Impacts (Use separate page if necessary referring to corresponding item)

Buffer Zone Setback:

If the project involves work in the buffer zone only, what is the shortest distance between project disturbance and the regulated resource area? 50-60 feet

Tree Cutting:

List the number of trees and approximate diameter of tree(s) in jurisdictional areas proposed for removal: (Use separate sheet if necessary.) One (1)

Fill & grading:

Amount of fill proposed for removal from site	<u>0</u>	cu yds.
Amount of fill proposed for use on site	<u>0</u>	cu yds.

Explain the difference between the proposed final grade and the existing conditions. No grade change proposed

Explain proposed site stabilization methodology during and post construction. Crane will be staged off site. Stump will be retained

10. If an exemption or waiver from the WPA or the Bellingham Wetland Bylaw will be required to complete the proposed project, the applicant shall, at the time of filing, provide information consistent with six requirements listed in Section 10 of the Bellingham Wetland Regulations.

11. The following completed items are included in each set of the filing:

☒ Abutters list, ☐ Abutter Notification Form, ☒ Affidavit of Service, ☒ Bylaw Fee Calculation, ☒ Worksheet & remittance ☒ Plans (see #8 above), ☐ Narrative for projects **Please include:** THUMB DRIVE with pdf copy of entire filing

12. **Statement of applicant:** I hereby certify under penalties of perjury that this application and all supporting plans and documents are true and complete to the best of my knowledge and that these have been prepared in conformance with the requirement of the Bellingham Wetlands Protection Bylaw and its attendant Regulations I further certify that all abutters and other parties have been notified of this application as required by the Bellingham Wetlands Protection Regulations. I understand that I may be asked to pay for a consultant to review my application for the Commission.

Initialed sign off by Treasurer's Office:

CERTIFICATION OF MUNICIPAL TAXES AND CHARGES PAID
TOWN OF BELLINGHAM

Property Information	
Parcel ID	0074-0067-0000
Map	
Lot	
Street Number	49
Street Name	Lakeshore Drive
First Name	Danielle
Last Name	D'Amato

As the
Collector

Taxes / Charges	Paid
Tax Title	<input checked="" type="checkbox"/>
Motor Excise Tax	<input checked="" type="checkbox"/>
Real Estate Tax	<input checked="" type="checkbox"/>
Personal Property Tax	<input checked="" type="checkbox"/>
Water	<input checked="" type="checkbox"/>
Sewer	<input checked="" type="checkbox"/>
Trash	<input checked="" type="checkbox"/>

As the Collector/Treasurer for the Town of Bellingham, MA I certify that the municipal taxes are paid in full for the above property.

Christine Mansfield
(Print name)

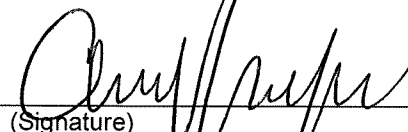
(Signature)

11/20/25
(Date)

Conservation Commission Category Activities and Fees

Category 1 (Fee for each activity is \$50):

- a.) work on single family lot; addition, pool, etc.;
- b.) site work without a house;
- c.) control vegetation;
- d.) resource improvement;
- e.) work on septic system separate from house;
- f.) monitoring well activities minus roadway;
- g.) new agricultural or aquaculture projects.

Category 2 (Fee for each activity is \$125)

- a.) construction of single family house;
- b.) parking lot;
- c.) beach nourishment;
- d.) electric generating facility activities;
- e.) inland limited projects minus road crossings and agriculture;
- f.) each crossing for driveway to single family house;
- g.) each project source (storm drain) discharge;
- h.) control vegetation in development;
- i.) water level variations;
- j.) any other activity not in Category 1, 3, or 4;
- k.) water supply exploration.

Category 3 (Fee for each activity is \$250)

- a.) site preparation (for development) beyond Notice of Intent scope;
- b.) each building (for development) including site;
- c.) road construction not crossing or driveway;
- d.) hazardous cleanup;
- e.) water supply development.

Category 4 (Fee for each activity is \$500):

- a.) each crossing for development or commercial road;
- b.) dam, sluiceway, tidegate (safety) work;
- c.) landfills operation/closures;
- d.) sand and gravel operations;
- e.) railroad line construction;
- f.) bridge;
- g.) hazardous waste alterations to resource areas;
- h.) dredging;
- i.) package treatment plant and discharge;
- j.) airport tree clearing;
- k.) oil and/or hazardous material release response actions.

Category 5 (Fee is \$2.00/linear foot):

- a.) Construction, repair, replacement of docks, piers, revetments, dikes, or other engineering structures on inland resource areas.

Revised 7/1/2013

**Town of Bellingham Wetlands Protection Bylaw
Fee Calculations Worksheet**
(Bylaw Fees are in addition to WPA Fees)
Fees must be submitted with application
(Check to be made payable to "Town of Bellingham")

1. A flat fee of \$50.00 each for the following requests: (check off appropriate item)

☒ Request for Determination of Applicability (RDA)..... \$ 50.00
(For RDA also see item 4 or 5 below as appropriate)
_____ Request for an Extension to Orders of Conditions (Ext)----- \$ _____

2. The following schedule applies for Notice of Intent (NOI) categories at 310CMR 10.03(7) (c), as follows:

*(Also complete Item #4 below for all filings including RDA, NOI and ANRAD and Item #5 for Riverfront Area if applicable.)

	No.	Total
Category 1	\$ 50.00 per activity x _____	= \$ _____
Category 2	\$125.00 per activity x _____	= \$ _____
Category 3	\$250.00 per activity x _____	= \$ _____
Category 4	\$500.00 per activity x _____	= \$ _____
Category 5	\$ 2.00 per linear ft. x _____	= \$ _____

3. A flat fee of \$50.00 for Request for an Amendment to each existing Order of Conditions permit:

\$ 50.00 per activity x _____ = \$ _____

4. Application for review of Resource Area Delineation: .20 per linear foot (not less than \$25.00 or more than \$200.00 for single family house projects; not less than \$50.00 or more than \$2,000.00 for any other activity).

- This fee will be in addition to the fee for a Request for Determination of Applicability (RDA) or Notice of Intent (NOI) listed in items #1 for RDA and #2 NOI or Abbreviated Notice of Resource Area Delineation (ANRAD).

Type of activity: _____
Total linear feet _____ x .20/linear foot = \$ _____
(\$25/ min. or \$2000/ max.)

5. Fees for projects within the Riverfront Area and another resource area shall be 150% of the above fees:
(Check off appropriate item below)

_____ Request for Determination of Applicability (RDA) \$ 50.00 x 150% = \$ _____
_____ Notice of Intent (NOI) (total from item 2 above) \$ _____ x 150% = \$ _____

Total Bylaw Fee Submitted \$ _____

DEP & BWP File No. _____

Name & Address of Applicant: Danielle D'Amato

Project name (if applicable): _____

Project location: Assessors Map: _____ Lot or Parcel: _____ Street Address: 49 Lakeshore Drive, Bellingham, MA 02019

Affidavit of Service
Under the Massachusetts Wetlands Protection Act &
Bellingham Wetlands Protection Bylaw

I, _____, hereby certify
Name of person making Affidavit
under pains and penalties of perjury that on _____

Date

I gave notification to abutters in compliance with the second paragraph of
Massachusetts General Law Chapter 131, Section 40, and the DEP Guide to
Abutter Notification dated April 8, 1994, in the connection with the following
matter:

A Notice of Intent/Abbreviated Notice of Resource Area Delineation/Request for Amendment was filed under
the Massachusetts Wetlands Protection Act and the Bellingham Wetlands Protection Bylaw, by

_____ with the
Name of applicant
_____ Conservation Commission on
Name of Municipality
_____ for property located at _____
Date

Address of land where work is proposed

The form of notification and a certified list of the abutters to whom it was given
and their addresses are attached to the Affidavit of Service.

Signature

Date

**NOTIFICATION TO ABUTTERS UNDER THE
MASSACHUSETTS WETLANDS PROTECTION ACT
CHAPTER 131, SECTION 40
AND**

THE TOWN OF BELLINGHAM WETLANDS PROTECTION BY LAW

In accordance with the second paragraph of Massachusetts General Laws Chapter 131, Section 40, and the Bellingham Wetlands Protection Bylaw, you are hereby notified of the following:

_____ has filed a
(Applicant)
Notice of Intent / Abbreviated Notice of Intent / Abbreviated Resource Area Delineation / Request for
Amendment with the Bellingham Conservation Commission for review of the following activity:

Description of Project:

The location of the proposed activity is:
Assessors Map _____ Lot/Parcel _____
Street Address: _____

Copies of the filing may be examined at the Bellingham Conservation Commission office during normal business hours (please call 508-657-2858) OR at the following:

Applicant or Representative Name: _____

Address: _____

Phone Number: _____

The public hearing will be held at the Bellingham Municipal Center, 10 Mechanic Street, Bellingham. Information on the date and time of the hearing may be directed to the Conservation Commission or the applicant's representative at the above numbers.

NOTE:

- Notice of the public hearing, including date, time and place:
- The public hearing notice will be published at least five (5) days in advance in the Woonsocket Call
- The public hearing notice will be posted at the Town Clerk's Office and on the town web site no less than forty-eight (48) hours in advance of the public hearing.
- The applicant may also contact the nearest Department of Environmental Protection Regional Office for more information about this application or the Wetlands Protection Act.
To contact DEP, call Central Regional (508)-792-7650

Checklist for filing under Bellingham Wetlands Protection Bylaw

Notice of Intent and Abbreviated Notice of Intent:

Completion of and submittal of three complete copies of the following:

- Notice of Intent Form or Abbreviated Notice of Intent Form
Please use WPA and Bellingham Wetlands Protection Bylaw Form found on the Conservation Commission page of the town website (bellinghamma.org) unless filing under Wetlands Protection Act only
Send appropriate copies to DEP
- Associated Stormwater Management forms if required
- Application for Permit under local bylaw
- Narrative on proposed work and mitigation as directed in Submittal Standards for small or large projects
- Abutter Notification Form
- Abutter list (certified from Board of Assessor's Office)
- Affidavit of Service-signed
- DEP Wetland transmittal form and associated town fee
- Bylaw fee form and associated fees (application fee & resource area verification fee)
- Plans as per Plan Specifications as outlined in "Section 29 Plan Requirements" of the Regulations
- Thumb Drive with pdf version of the entire filing

Request for Determination of Applicability:

Completion of and submittal of three complete copies of the following:

- RDA Form
Please use WPA and Bellingham Wetlands Protection Bylaw Form found on the Conservation Commission page of the town website (bellinghamma.org) unless filing under Wetlands Protection Act only (Send appropriate signed copy to DEP)
- Application for Permit under local bylaw
- Narrative on proposed work and mitigation as directed in Submittal Standards for small or large projects
- Bylaw fee form and associated fees (application fee & resource area verification fee)
- Associated Plans
- Thumb Drive with pdf version of the entire filing

Request for Extension to an existing Order of Conditions:

Completion of and submittal of three copies of the following:

- Letter submittal requesting Extension including reasons for request
- Bylaw fee form and associated fee

Request for Amendment to an existing Order of Conditions:

Completion of and submittal of three complete copies of the following:

- Letter submittal requesting Amendment including reasons for request
- Application for Permit under local bylaw
- Narrative on proposed work and mitigation as directed in Submittal Standards for small or large projects
- Bylaw fee form and associated fee
- Associated Plans
- Thumb Drive with pdf version of the entire filing

Request for Certificate of Compliance:

Completion of and submittal of three copies of the following:

- Request for Certificate of Compliance Form 8A (Please use WPA and Bellingham Wetlands Protection Bylaw Form found on the Conservation Commission page of the town website (bellinghamma.org) unless filing under Wetlands Protection Act only)
- As built Plans signed and stamped
- Thumb Drive with pdf version of the entire filing



Danielle D'Amato <ddamato23@gmail.com>

Arborist letter

Sean Webber @ Charron Tree Services <sean.webber@charrontreeservices.com>

Tue, Nov 18, 2025 at 12:49 PM

To: ddamato23@gmail.com

Andrew Sutherland, Certified Arborist
Charron Tree Service
1060 Pulaski Blvd
Bellingham, MA 02019
charrontreeservice.com
508-883-8823
November 17, 2025

Bellingham Conservation Commission
Bellingham Town Hall
10 Mechanic Street
Bellingham, MA 02019

Dear Members of the Bellingham Conservation Commission,

I am submitting this letter as a certified arborist with Charron Tree Service on behalf of the property owner at [49 Lake Shore Drive, Bellingham, MA](#), to request approval for the removal of a mature Northern Red Oak (*Quercus rubra*) located in the rear yard on a steep slope. The tree has a diameter at breast height (DBH) of 21.65 inches.

Upon inspection, I observed that the tree has developed a significant lean toward the neighboring residence. Additionally, the tree is in close proximity to the home, which increases risk should failure occur. The steep grade on which the tree is growing, combined with signs of potential rot at the base and indications of a potentially compromised root structure, further elevates the likelihood of structural failure, particularly during storm or high-wind events. These combined factors present a clear hazard to the adjacent property and its occupants.

Due to site limitations and the position of the tree, a crane will be required to safely perform the removal. With permission from the neighboring property owner, the crane will be set up in their driveway, which provides the only safe and feasible access point to properly and securely dismantle the tree. To maintain slope stability and minimize erosion, the stump will be left in place following removal.

Charron Tree Service will conduct the removal in accordance with Massachusetts tree-care standards and accepted arboricultural best practices, and we will comply with any conditions or requirements established by the Conservation Commission.

Thank you for your time and consideration. I am available to provide photographs, additional documentation, or to meet on-site if the Commission requires further information.

Sincerely,
Andrew Sutherland
Certified Arborist
Charron Tree Service



Proposal #1253

Created: 11/17/2025

From: Sean

1060 Pulaski Boulevard Bellingham, MA 02019

(508)-883-8823

Proposal For

Danielle D'Amato

49 Lakeshore Dr
Bellingham, MA 02019

mobile: 508-944-5173
ddamato23@gmail.com

Location

49 Lakeshore Dr
Bellingham, MA 02019

49 Lakeshore Dr 02019

Terms

Due on receipt

ITEM DESCRIPTION	QUANTITY	UNIT PRICE	AMOUNT
1) Tree Removal -Remove one large red oak tree back yard, leaning over the neighbors house. -Remove all wood and brush. -Must access the neighbors driveway with the crane as discussed. *Conservation must give permission for the removal*	1 MH	\$ 2,000.00	\$ 2,000.00
2) Police Detail (Half Day) Half Day	1	\$ 350.00	\$ 350.00

All work will be completed in accordance with these plans unless subsequent changes are agreed upon in writing. Balances not paid by the due date are subject to late fees.

SUBTOTAL	\$ 2,350.00
SALES TAX	\$ 0.00
TOTAL	\$ 2,350.00

Signature

x

Date:

Please sign here to accept the terms and conditions

Sales Reps

Sean

Office: [508-883-8823](tel:508-883-8823)

Mobile: [774-571-1175](tel:774-571-1175)

sean.webber@charrontreeservices.com

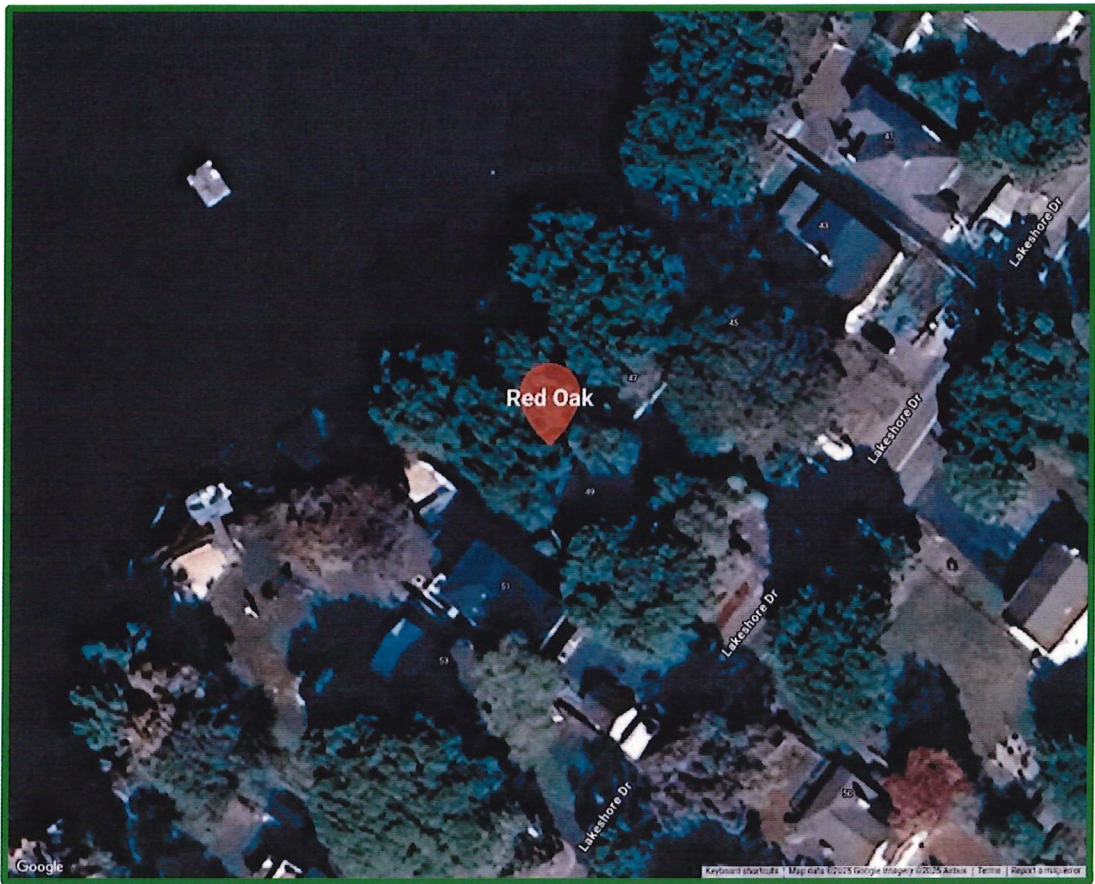

ID	DESCRIPTION	COLOR
Red Oak	Remove	

Charron Tree Service – Terms and Conditions

1. Performance by Company

Charron Tree Service ("Company") shall use reasonable efforts to meet the performance and completion dates as agreed upon with the customer. However, the Company shall not be held liable for any delays resulting from circumstances beyond its reasonable control, including but not limited to inclement weather, acts of God, unforeseen site conditions, mechanical failures, or other events beyond the Company's control.

2. Workmanship

The Company agrees to perform all services in a professional, competent, and safe manner, utilizing experienced personnel, appropriate tools, and equipment. Unless otherwise specified in writing, Charron Tree Service shall be responsible for the removal of all wood, brush, and debris resulting from the performance of the work.

3. Insurance

Charron Tree Service maintains comprehensive liability insurance to cover any injury to persons or damage to property arising from the performance of the services provided. In addition, all employees are covered by Workers' Compensation Insurance in accordance with applicable state and federal laws.

4. Property Ownership and Site Conditions

The customer warrants that they either own the property upon which the work is to be performed or have obtained the necessary authorization from the rightful property owner to authorize the work. The customer agrees to indemnify and hold harmless Charron Tree Service, its employees, and agents from any claims, damages, or legal actions arising from the customer's failure to secure such authorization.

The customer is responsible for identifying and clearly marking all non-public or private underground utilities (including but not limited to irrigation systems, septic systems, and private wiring). The Company shall not be liable for any damage to underground utilities or property not clearly marked by the customer prior to the commencement of work. Stump grinding and removal services will only be performed in areas where public utilities have been located and cleared by the customer.

5. Terms of Payment

Unless otherwise agreed in writing, all payments are due in full upon completion of the work on the date of service. If payment is not received within the specified time, the customer agrees to be responsible for any costs incurred in the collection of the outstanding balance, including but not limited to attorney's fees, court costs, and collection agency fees.

Accepted payment methods include:

- Cash
- Check
- Credit Card (subject to a 2.9% processing fee plus \$0.20 per transaction)
- ACH (Bank Transfer) (subject to a 1% processing fee, capped at \$10)

6. Damage Waiver and Property Access

The customer acknowledges that the equipment and vehicles used by Charron Tree Service for tree care services are large and heavy, and may cause damage when accessing various areas of the property, including but not limited to driveways, sidewalks, lawns, sprinkler systems, underground utilities, and septic systems.

While the Company will take reasonable precautions to minimize potential damage, including the use of protective materials such as plywood, the customer hereby releases Charron Tree Service, its employees, and agents from any and all liability for property damage caused by the use of equipment or vehicles in the course of providing services. This waiver includes, but is not limited to, damage to driveways, walkways, lawns, and other areas of the property.

